

Acrylic Tray Cleaning Notice:

Regular cleaning of your Lennox Tray is recommended and will help to avoid the build up of dirt and grime that can damage and reduce the life of the tray.

To keep your tray in good condition, it is recommended that residual water spots should be removed from all surfaces after each use. This can be achieved by using a soft squeegee or sponge.

For tougher stains and grease build up, a solution of mild soap and hot water should be used with a soft cleaning cloth.

To protect your tray, please ensure you avoid abrasive chemicals such as ammonia, bleach or hydrochloric acid, or as they can do more damage than good. Many bathroom cleaners may contain chemicals that could adversely affect the finish so should only be used with caution at the consumers's risk.

Lennox Shower Tray and Wall Liner **INSTALLATION GUIDE**



**THE LENNOX™
BATHROOM**
Ideas for life style

Auckland Ph:09 2710168

Hamilton Ph:07 8477722

Christchurch Ph:03 3488885

Dunedin Ph:03 4775885

Nelson Ph : 03 5488858

Online Order: www.lennoxbathroom.co.nz

CONTENTS SUPPLIED

Lennox Shower Tray / Pack contains

1 x Shower Tray

Shower Wall Liner / Pack contains

1 x Shower Wall Liner

IMPORTANT NOTE:

Shower Waste Excluded

3 x Shower Bond Adhesive 1 x Clear Anti-Fungal Silicone
Excluded

TOOLS REQUIRED

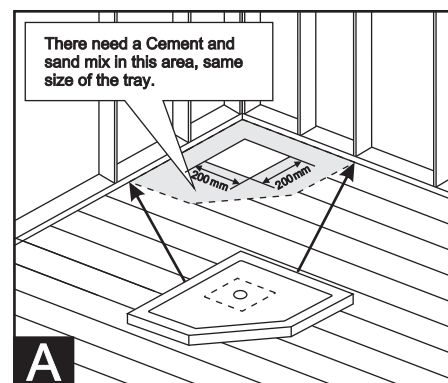
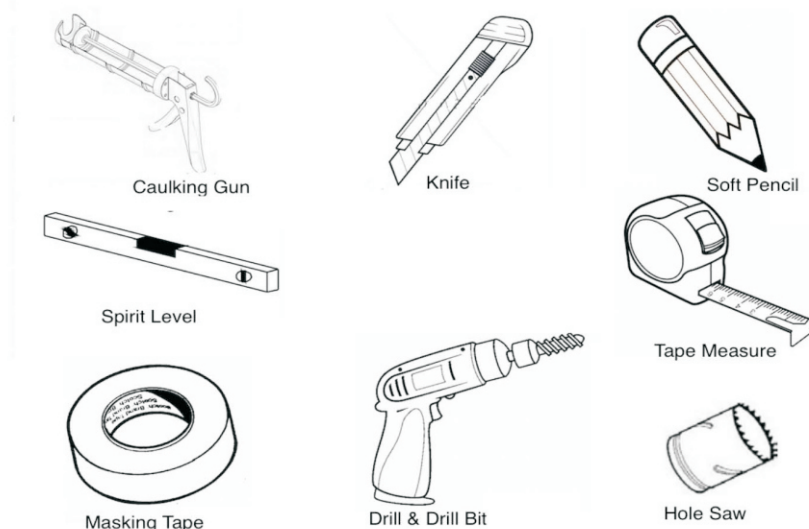

A. TIMBER FLOOR

1. Floor boards or sheet flooring must cover the entire underside of base. Cut hole through floor no greater than 200mm x 200mm.
Note: If renovating, please check floorboards for soundness. Rotting may have occurred and flooring may need replacing.
2. Spread a 10mm min. thick mortar bed of 4:1 Washed Sand Cement over entire area where base is to be installed and trowel off level, or use a cement based tile adhesive spread on floor with a 12mm notched trowel to ensure all base is fully supported.
3. Lay shower base on prepared levelled mortar bed and using a spirit level ensure base is level both side to side and front rear. This will allow base to drain effectively as it has inbuilt fall to the waste outlet.
4. Finally it is imperative to test for water run off to the waste outlet prior to lining shower walls. This will ensure base is draining correctly. Failure to do so will be a breach of the guarantee.

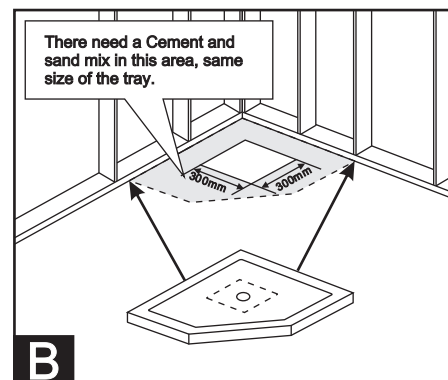

B. CONCRETE SLAB

1. Boxed opening in slab must not exceed 300mm in width underneath shower base.
2. Spread a 10mm min. thick mortar bed of 4:1 Washed Sand/Cement over entire area where base is to be installed and trowel off level or use a cement based tile adhesive spread on floor with a 12mm notched trowel to ensure all base is fully supported.
3. Lay shower base on prepared levelled mortar bed and using a spirit level ensure base is level both side to side and front to rear. This will allow base to drain effectively as it has inbuilt fall to the waste outlet.
4. At this point it is imperative to test for water run off to outlet prior to backfilling opening in slab to ensure base drains correctly. Failure to do so will be a breach of the guarantee.
5. Backfill opening in slab with a 4:1 Washed Sand and Cement Mix ensuring the mortar is packed tightly around waste outlet and all the way back into the boxed section of the slab and up to the under side of the base to give full support around the outlet. Note: Where required by regulation plastic pipe & fittings may need to be lagged prior to back filling. Note: It is recommended installation practice to check the edge of the shower base into the wall by the width of the tiling flange in order to provide a leak-free join with the wall cladding material (see diagram).

We recommend using Cement and Sand mix or Foam underneath the shower tray during installation. This helps distribute weight evenly, reducing the risk of damage to the tray.

Before installation, please ensure the floor surface is level. An uneven floor may also lead to potential damage to the tray.

Please note, we will not be held responsible for any damage caused due to improper installation.

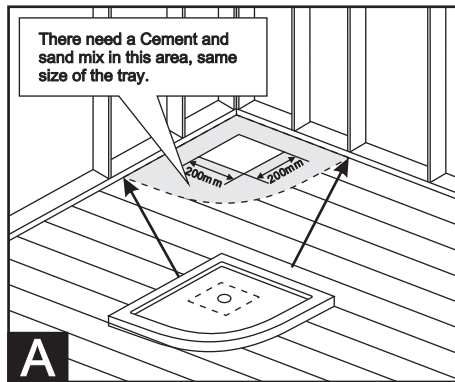

A. TIMBER FLOOR

1. Floor boards or sheet flooring must cover the entire underside of base. Cut hole through floor no greater than 200mm x 200mm.
Note: If renovating, please check floorboards for soundness. Rotting may have occurred and flooring may need replacing.
2. Spread a 10mm min. thick mortar bed of 4:1 Washed Sand Cement over entire area where base is to be installed and trowel off level, or use a cement based tile adhesive spread on floor with a 12mm notched trowel to ensure all base is fully supported.
3. Lay shower base on prepared levelled mortar bed and using a spirit level ensure base is level both side to side and front rear. This will allow base to drain effectively as it has inbuilt fall to the waste outlet.
4. Finally it is imperative to test for water run off to the waste outlet prior to lining shower walls. This will ensure base is draining correctly. Failure to do so will be a breach of the guarantee.

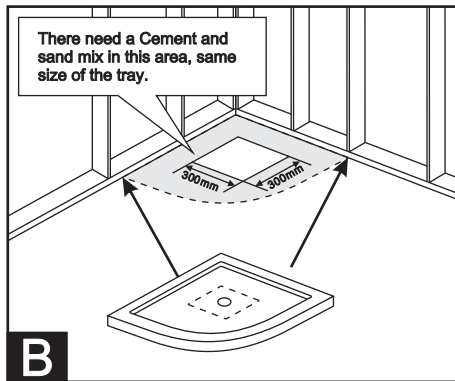

B. CONCRETE SLAB

1. Boxed opening in slab must not exceed 300mm in width underneath shower base.
2. Spread a 10mm min. thick mortar bed of 4:1 Washed Sand/Cement over entire area where base is to be installed and trowel off level or use a cement based tile adhesive spread on floor with a 12mm notched trowel to ensure all base is fully supported.
3. Lay shower base on prepared levelled mortar bed and using a spirit level ensure base is level both side to side and front to rear. This will allow base to drain effectively as it has inbuilt fall to the waste outlet.
4. At this point it is imperative to test for water run off to outlet prior to backfilling opening in slab to ensure base drains correctly. Failure to do so will be a breach of the guarantee.
5. Backfill opening in slab with a 4:1 Washed Sand and Cement Mix ensuring the mortar is packed tightly around waste outlet and all the way back into the boxed section of the slab and up to the under side of the base to give full support around the outlet. Note: Where required by regulation plastic pipe & fittings may need to be lagged prior to back filling. Note: It is recommended installation practice to check the edge of the shower base into the wall by the width of the tiling flange in order to provide a leak-free join with the wall cladding material (see diagram).

WARNINGS

Installation of Lennox Products **MUST** be carried out by a **QUALIFIED TRADESPERSON**.

Inspect the product and all components (listed) **PRIOR TO INSTALLATION**.

Please inspect that the product is not damaged, immediately contact supplier if there is any damage.

To prevent damage during process of installation, we strongly recommend placing cardboard or likewise product as protection.

Installation of damaged goods will **VOID** your warranty.

Lennox acrylic products shall not be used directly adjacent to any direct heat source above 70 degrees Celsius, as this may cause distortion of the product.

Lennox acrylic products will expand and contract with temperature changes, so it is important to allow expansion gaps where shown in this instruction.

Lennox Acrylic products may have sharp edges, so always wear appropriate protective clothing and footwear during the installation process.

We recommend using Cement and Sand Mix or Foam underneath the shower tray during installation. This helps distribute weight evenly, reducing the risk of damage to the tray. Before installation, please ensure the floor surface is level. An uneven floor may also lead to potential damage to the tray. Please note, we will not be held responsible for any damage caused due to improper installation.

AREA PREPARATION

To ensure correct installation of Lennox Shower products, it is important to have the site floor and walls; level; square and plumb to within 5mm overall.



All floor and wall surface joints and fixings must be flush to prevent unevenness on the Lennox shower products, potentially causing stress points or unsightly bulges.

Lennox Shower Base and Acrylic Shower Wall Lining products must be fitted to a structurally sound solid surface that does not flex under load. This will prevent unevenness in the product or potential weak spots.

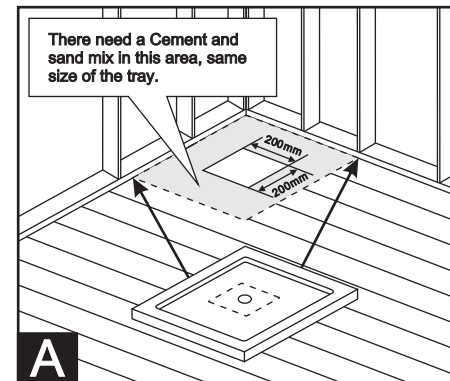

A. TIMBER FLOOR

1. Floor boards or sheet flooring must cover the entire underside of base. Cut hole through floor no greater than 200mm x 200mm.
Note: If renovating, please check floorboards for soundness. Rotting may have occurred and flooring may need replacing.
2. Spread a 10mm min. thick mortar bed of 4:1 Washed Sand Cement over entire area where base is to be installed and trowel off level, or use a cement based tile adhesive spread on floor with a 12mm notched trowel to ensure all base is fully supported.
3. Lay shower base on prepared levelled mortar bed and using a spirit level ensure base is level both side to side and front to rear. This will allow base to drain effectively as it has inbuilt fall to the waste outlet.
4. Finally it is imperative to test for water run off to the waste outlet prior to lining shower walls. This will ensure base is draining correctly. Failure to do so will be a breach of the guarantee.

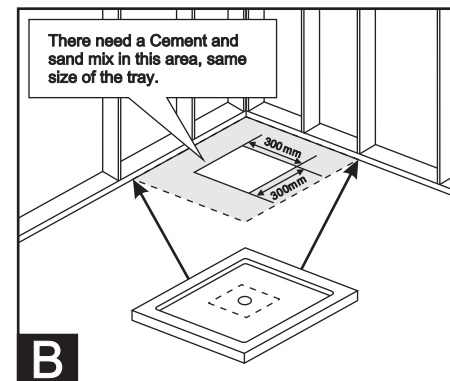

B. CONCRETE SLAB

1. Boxed opening in slab must not exceed 300mm in width underneath shower base.
2. Spread a 10mm min. thick mortar bed of 4:1 Washed Sand/Cement over entire area where base is to be installed and trowel off level or use a cement based tile adhesive spread on floor with a 12mm notched trowel to ensure all base is fully supported.
3. Lay shower base on prepared levelled mortar bed and using a spirit level ensure base is level both side to side and front to rear. This will allow base to drain effectively as it has inbuilt fall to the waste outlet.
4. At this point it is imperative to test for water run off to outlet prior to backfilling opening in slab to ensure base drains correctly. Failure to do so will be a breach of the guarantee.
5. Backfill opening in slab with a 4:1 Washed Sand and Cement Mix ensuring the mortar is packed tightly around waste outlet and all the way back into the boxed section of the slab and up to the under side of the base to give full support around the outlet. Note: Where required by regulation plastic pipe & fittings may need to be lagged prior to back filling. Note: It is recommended installation practice to check the edge of the shower base into the wall by the width of the tiling flange in order to provide a leak-free join with the wall cladding material (see diagram).

We recommend using Cement and Sand Mix or Foam underneath the shower tray during installation. This helps distribute weight evenly, reducing the risk of damage to the tray.

Before installation, please ensure the floor surface is level. An uneven floor may also lead to potential damage to the tray.

Please note, we will not be held responsible for any damage caused due to improper installation.

Reposition the shower wall liner. Use a damp cloth and press towards the edges to ensure full contact has been made over the entire shower liner area.

Ensure site is left for 20 minutes to cure and then brace as required to hold in position.

Bracing should remain in position for not less than 18 hours for complete curing.

AFTER INSTALLATION

Once Wall lining adhesion is fully cured, remove the protective film on the shower wall liner completely.

The protective film on the remainder of the Shower Tray can also be removed and the Chrome Waste Cover fitted.

Apply silicone sea slant provided around the tap hole penetrations to waterproof the gaps. A qualified tradesperson can now fit the tap sets over the wall liner.

DO NOT USE THE SHOWER FOR AT LEAST 24 HOURS AFTER FINAL INSTALLATION TO ALLOW FOR FULL CURE

IMPORTANT:

- Hole cut out for waste must not exceed 170mm square
- Concrete floors must be back filled around the waste area or where any additional cuts in the concrete have been made with concrete (or a similar solid fill material)



SHOWER BASE INSTALLATION FOR ACRYLIC SHOWER WALL APPLICATIONS

A. For Acrylic Shower Wall Liner applications the Lennox Shower Base does not need checking into the stud wall, but can be simply pushed against the stud frame. The shower base can be installed before the GIB board sheeting is applied.

B. If the Shower Base is to be installed after the GIB board is installed, the GIB board sheet will need to be cut away to allow the base to sit against the stud wall, allowing a 6mm gap all around the shower base.

C. All Lennox Shower Bases are manufactured with a protective film to prevent damage to the surface of the product.

D. Prior to installation, pull the protective film back from the edges of the shower base (Approx 25mm) and completely from the waste area.

E. Ensure the floor surface is clean and dry. Apply a generous amount of building adhesive to the Shower Base Self supporting feet - suitable for concrete bond (adhesive not supplied – liquid Nails or similar).

F. Position the Shower Base against the wall studs and push the Shower Base down firmly to bed the feet against the floor. Recheck the Shower Base level and conduct a water test to ensure full drainage to the waste. Re level the base as required whilst adhesive is still uncured.

G. Ensure extra stud installed as shown in the diagram below to ensure the glass door is strongly supported.



H. Allow the Shower Base to cure for at least 24 Hours as per the adhesive manufacturer's instructions before installing the wall sheeting. This ensures the level will not change by standing on it.

sealant along the inside face of the tile bead up stand of the shower base as shown below.

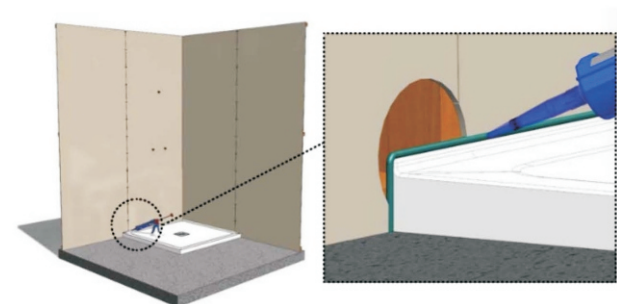

FIXING SHOWER WALL LINER

YOU WILL ONLY HAVE 20 MINUTES TO COMPLETE THE GLUEING PROCESS

Place the wall lining into position ensuring that the corner area is pressed into place first. Note the bottom edge of the shower wall liner should be sitting hard on the shower base, in front of the tile bead.

Trim the bottom of liner if required to ensure that the liner stand perpendicular on the tray and against the wall.

Apply pressure from the inner corner to outside edge.

Remove the shower wall liner from position for approximately 5 seconds to allow the adhesive to aerate.

Adhering Shower Wall Liner

- Prepare area by wiping down the shower wall, base and GIB board ensuring it is clean and dry.

The shower liner is adhered to the GIB board using Shower bond adhesive . Please read the manufacturer's instructions on the back of the Shower bond cartridge before use.

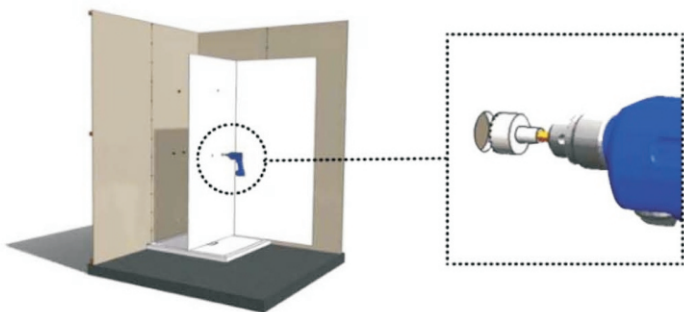

Apply vertical lines of Shower bond adhesive on the GIB board, 100mm apart to cover the remainder of the wall liner area.

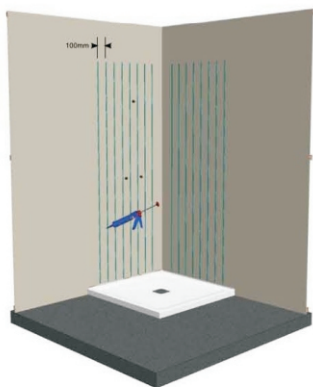

Before fitting the shower wall liner, apply a bead of silicone

I. Once the Shower Base bond is fully cured, the Wet area sheeting can be applied over the Shower Base tile bead as per the relevant Wet Board manufacturer's instructions. The GIB board should sit over the top edge of the tile bead. Ensure the GIB board is installed above the shower base tile bead for expansion.

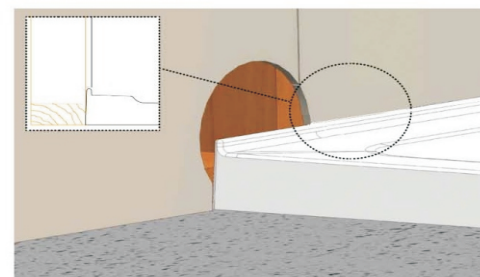

J. Once sheeting is completed, use a flexible waterproof sealant (not supplied) to seal the gap between the Shower Base tile bead and the GIB board.

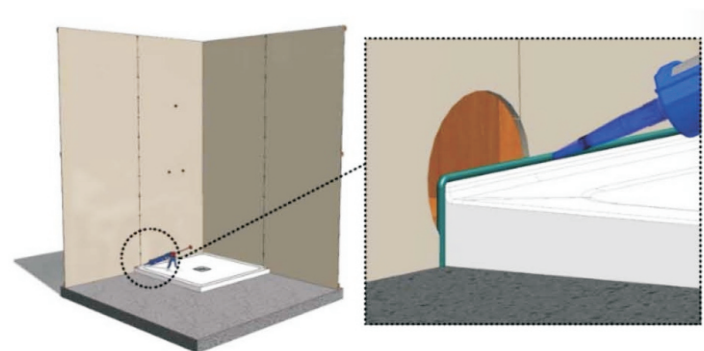

ACRYLIC SHOWER WALL LINER INSTALLATION

DRILLING TAP HOLES IN ACRYLIC LINER

Have a qualified tradesperson install the shower fittings. Mark the position of the holes for the fittings on acrylic shower wall liner.



- Large holes must be drilled with a FINE tooth hole saw.
- Holes should be drilled from the outside show face only

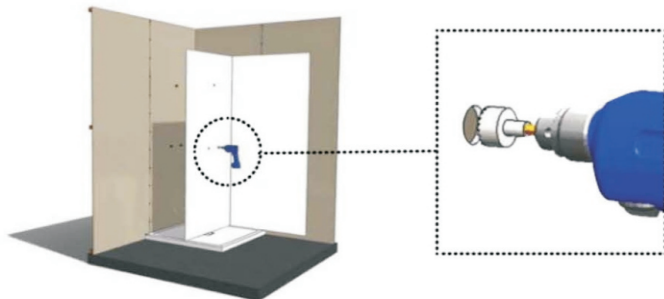

Ensure all final hole sizes have at least a 2mm clearance around tap fittings for expansion.

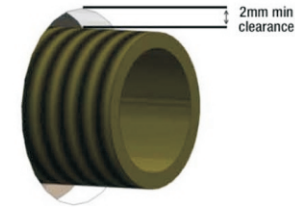

ATTACHING THE ACRYLIC SHOWER WALL LINER

Positioning Shower Wall Liner

- Trial position the shower wall liner against the shower recess, ensuring it fits squarely into the recess corner and shower base.
- Tape the corners with masking tape to hold the liner in position.
- Use a soft pencil to mark around the edges of the shower wall liner before removing.

